

**BeamClamp**  
**Type Gratefix M08**  
 To suit grating with 30-41mm centre load bars

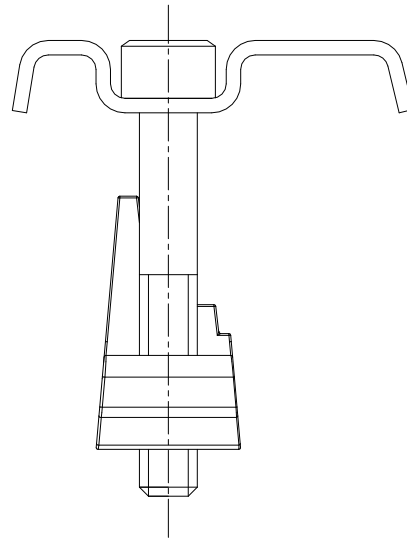
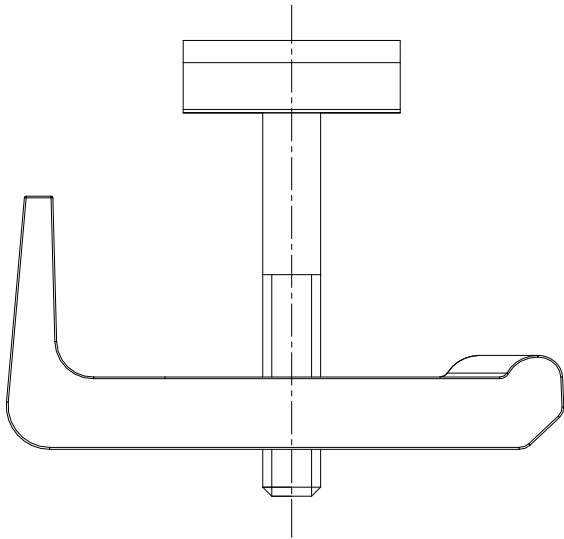

This block is a true representation of a BeamClamp Gratefix. It is designed to allow open floor grating to be connected to the supporting steelwork without any penetration of the steelwork and no access to the underside is required. Please refer to web site or technical literature for full details of its use.

[www.beamclamp.com/resources/beamclamp-configurator](http://www.beamclamp.com/resources/beamclamp-configurator)

Kee Safety Ltd

Web site: [www.beamclamp.com](http://www.beamclamp.com)

Email: [sales@beamclamp.com](mailto:sales@beamclamp.com)

T: 0044 (0) 1384 632188

F: 0044 (0) 1384 632192

